



INSTRUCTIONS

-J01544

REV. 6-21-02

Kit Number 70264-94A

TWO-INTO-ONE WIRING HARNESS ADAPTER

General

This harness adapter is designed for use on 1994 and later FLTR, FLT, FLHT and FLHR models. The adapter allows 12 vdc and a ground connection to be supplied to two accessories. The two accessories can be turned "ON" and "OFF" by the accessory switch.

QTY.	DESCRIPTION
1	Harness adapter

All Service Parts are listed below.

Installation

- See Illustration. Connect the socket connector half (1) to the accessory pin connector half located forward of the battery.
- Connect the accessory connectors to the pin connector halves (2). Turn accessory switch "ON" and "OFF" to check for proper operation.

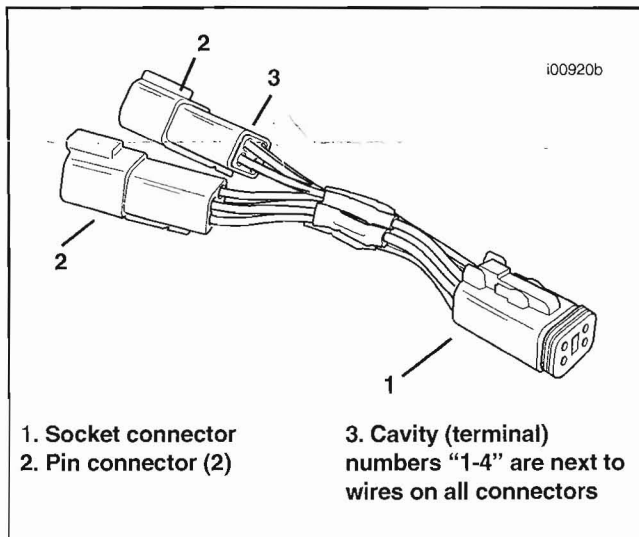

Illustration. Two-Into-One Harness Adapter



Service Parts

Part No. 70264-94A

Date 6/02

TWO-INTO-ONE HARNESS ADAPTER

i04972a

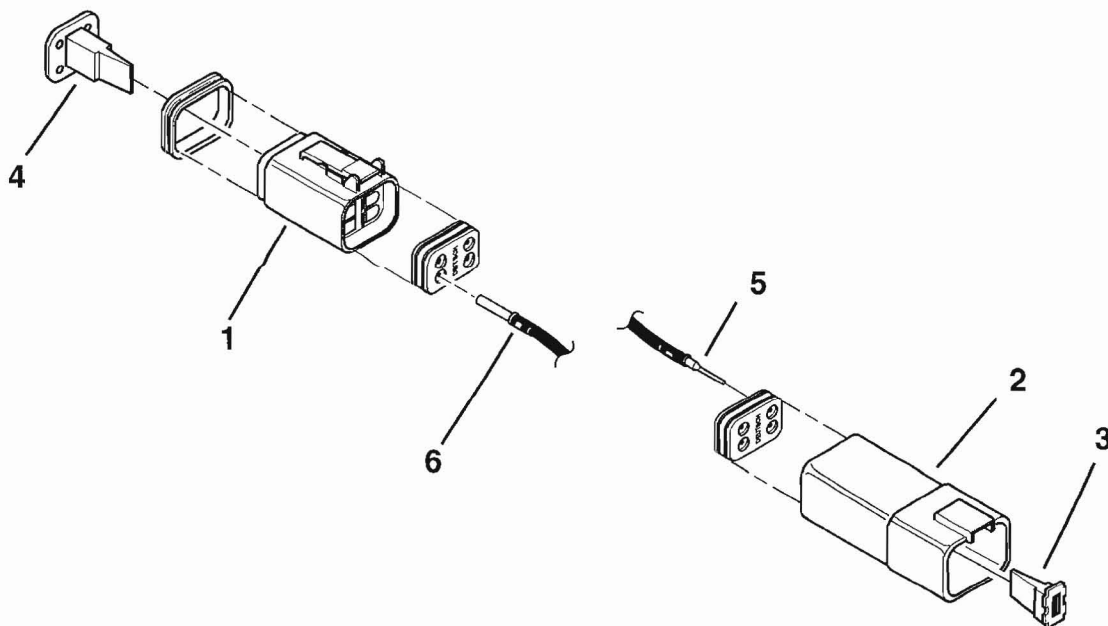

Item	Description	Part No.	Item	Description	Part No.
1	Socket housing	72114-94BK	4	Socket lock, secondary	72154-94
2	Pin housing (2)	72104-94BK	5	Pin terminal (8)	72190-94
3	Pin lock, secondary	72144-94	6	Socket terminal (4)	72191-94